

## Gara de Nord

## Commercial Spaces

### CARACTERISTICS

- ▶ **AREA:** Gara de Nord
- ▶ **Usable surface:** 180.67 sqm
- ▶ **Land Surface:** 82.18 sqm
- ▶ **Maximum height:** S+P

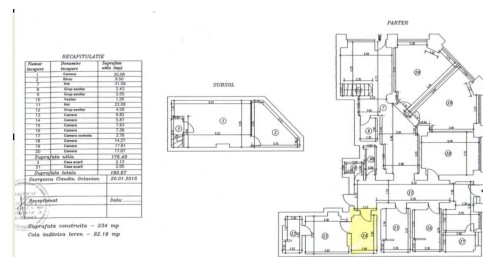

### FINISHES/EQUIPMENT

- ▶ **Others:** AC

### DESCRIPTION

The commercial space is situated in the Northern Railway Station area, benefiting of a great visibility.

Total usable area: 180.67 sqm

Ground floor: 151.09 sqm

Basement: 29.54 sqm

Afferent land 82.18 sqm

The space is disposed on the basement and on the ground floor.

Facilities:

2 streets opening

sanitary group

own central heating

the basement is arranged for offices;

4 air conditioning

300,000 EUR

5 BITCOIN

102.01 ETHEREUM