

Calea Mosilor

Commercial Spaces for Rent

CARACTERISTICS

- ▶ **AREA:** Calea Mosilor
- ▶ **Usable surface:** 307 sqm
- ▶ **Maximum height:** S+P
- ▶ **Showcase:** 16

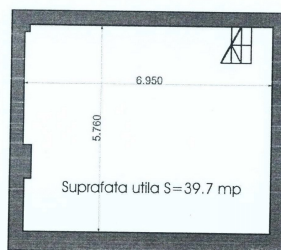

DESCRIPTION

The space is located on Calea Mosilor, benefiting from intense car and pedestrian traffic.
The space is located on the basement + ground floor.

Facilities:

Generous showcase
Open space
Access to supply
Ground floor: 267.06 sqm
Basement: 40 sqm

9,144 EUR

0.09 BITCOIN

2.38 ETHEREUM