

Kiseleff Blvd

House for Rent

### CARACTERISTICS

- ▶ **AREA:** Kiseleff Blvd
- ▶ **Usable surface:** 695 sqm
- ▶ **Built surface:** 951.44 sqm
- ▶ **Land Surface:** 975 sqm
- ▶ **No. of Rooms:** 10
- ▶ **No. of Bathrooms:** 9
- ▶ **Maximum height:** S+P+1+M

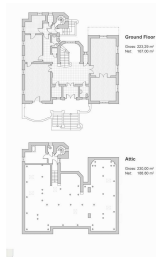

### Layout

Disposed on: B + GF + 1F + A

Built area: 951.44 sqm

Land plot: 975 sqm

Basement:

Gross area: 268.15 sqm

Net area: 176 sqm

Ground floor:

Gross area: 223.29 sqm

Net area: 167 sqm

First floor:

Gross area: 230 sqm

Net area: 163 sqm

Attic:

Gross area: 230 sqm  
Net area: 188.80 sqm

## DESCRIPTION

The villa offered for rent has a great history and a beautiful location, in Kiseleff area , close to Arch of Triumph, Kiseleff Park, Herastrau Park or Casin Monastery. The access in the area is very easy due to the infrastructure.

History:

The villa built in the interwar period has a special architectural value. It is an amazing building included in the Halfon Parcelling. That parcelling was named Halfon after the initiator, Rafael Halfon (1882 –1955). Rafael Halfon is the great-grandson of a known banker, at the time, and initially, mentioned that he wants houses for his own use.

In May 1922, the architect Stefan Burcus submitted on behalf of the owner Rafael Halfon an application for the authorization of 5 villas in Kiseleff.

That amazing house is the first of the 5 villas. It was inhabited by Marshal Alexandru Averescu with his wife, Clotilda Caligaris, who was primadonna at the "Scala in Milan".

Alexandru Averescu was a Romanian marshal, general and commander of the Romanian Army during the First World War, being often credited for Romania's few military successes. He was also the 24th Prime Minister of Romania in three separate cabinets ( and was interim Minister of Foreign Affairs from January to March 1918 ). Averescu was the author of 12 works on military issues ( including a volume of memories from the front line )

The initiator Rafael Halfon, kept the second villa for himself.

20,000 EUR

0.34 BITCOIN

11.54 ETHEREUM