

# Calea Dorobantilor

## Commercial Spaces

## CARACTERISTICS

- ▶ **AREA:** Calea Dorobantilor
- ▶ **Usable surface:** 24 sqm
- ▶ **No. of Bathrooms:** 2
- ▶ **Floor:** P
- ▶ **Construction year:** 1953

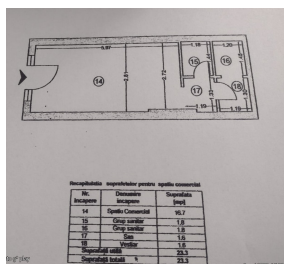

### DESCRIPTION

The space is located on the ground floor of a building built in 1953 and has the destination of commercial space. The space is arranged on the buried ground floor.

Facilities:

All utilities

### Opening at a street

Terrace 14 sqm

2 sanitary groups

Total usable area: 24 sqm

**168,000 EUR**

1.71 BITCOIN

## 41.36 ETHEREUM