

Magheru Blvd

Commercial Spaces for Rent

CHARACTERISTICS

- ▶ **AREA:** Magheru Blvd
- ▶ **Maximum height:** S+P



Plan parter

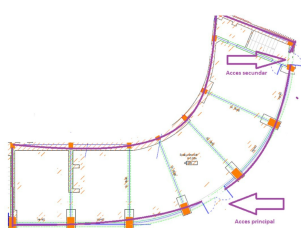

Plan subsol



DESCRIPTION

The space is located on Magheru Boulevard, benefiting from both car and pedestrian traffic, and offers exceptional visibility. The property is arranged on Ground Floor + Basement.

Facilities:

Restroom

Kitchenette

Large storefront

Perfectly suitable for a luxury retail store, well-known brands, or a bank.

Total usable area: 259 sqm

Usable area – ground floor: 128 sqm

Usable area – basement: 131 sqm

Rent:

€55/sqm/month – ground floor
€20/sqm/month – basement

55 EUR sqm

0.04 ETHEREUM sqm