

Ulmi

Land for Sale

CARACTERISTICS

- ▶ **AREA:** Ulmi
- ▶ **Usable surface:** 99960 sqm
- ▶ **Built surface:** 51579 sqm
- ▶ **Land Surface:** 99960 sqm
- ▶ **POT:** 60
- ▶ **CUT:** 1
- ▶ **End-use:** Industrial
- ▶ **No. of openings:** 2

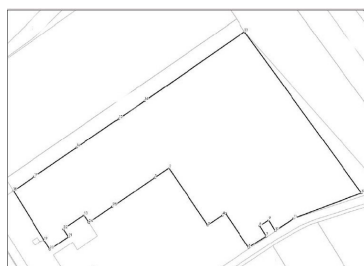
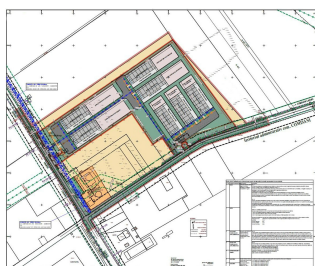

DESCRIPTION

The industrial land plot offered for sale represent an excellent investment opportunity.

The land plot is located in Ulmi, Dâmbovița County, having in the immediate vicinity many important companies in Romania, such as Arctic, Beko, Kablutronik.

The property benefits from direct frontage to two major roads – DN71 (national road) and DCL414 (local road), ensuring high accessibility and visibility for industrial or logistics development.

LAND PLOT: 99,360 sqm

Opening to: DN71 — 116.31 sqm

DCL414 — 209.69 sqm

PUZ approved For industrial development

CUT: 1

POT 60%

H max: 15 m

19 EUR sqm

0.01 ETHEREUM sqm