

Tineretului Park

Commercial Spaces for Rent

CARACTERISTICS

- ▶ **AREA:** Tineretului Park
- ▶ **Usable surface:** 389 sqm
- ▶ **Floor:** 1
- ▶ **Showcase:** Da

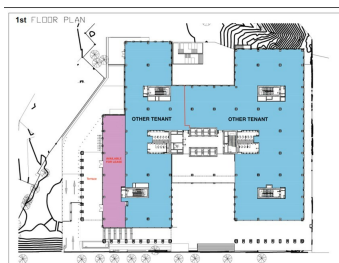

FINISHES/EQUIPMENT

- ▶ **Others:** AC, Faience, Sandstone, Parquet, Insulated Windows

DESCRIPTION

Office buildings are located in the immediate vicinity of the Gheorghe ?incai metro station, overlooking Tineretului Park, just one stop away from Pia?a Unirii. The space is designated for commercial use, is situated on the 1st floor, and can easily accommodate a showroom or even a restaurant. On the left side of the building, the space benefits from direct access at street level.

Facilities:

- Green building
- suspended ceiling
- BMS (Building Management System)
- 4-pipe HVAC system
- large storefront window
- spacious terrace
- fire detection system
- 3 parking spaces
- Retail area: 389 sqm + 182 sqm terrace